

CUSTOMER PART No.

CUSTOMER

CAN ART STD.

DIE No.

EH05314

DESCRIPTION

1 1/2" SCHEDULE 80 PIPE

PROPOSAL No.

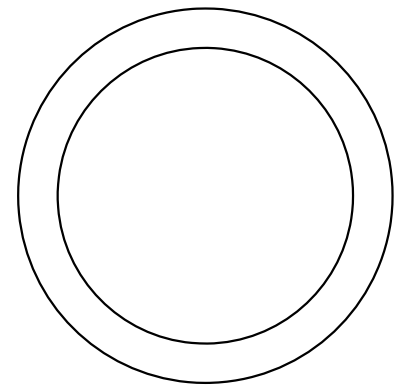
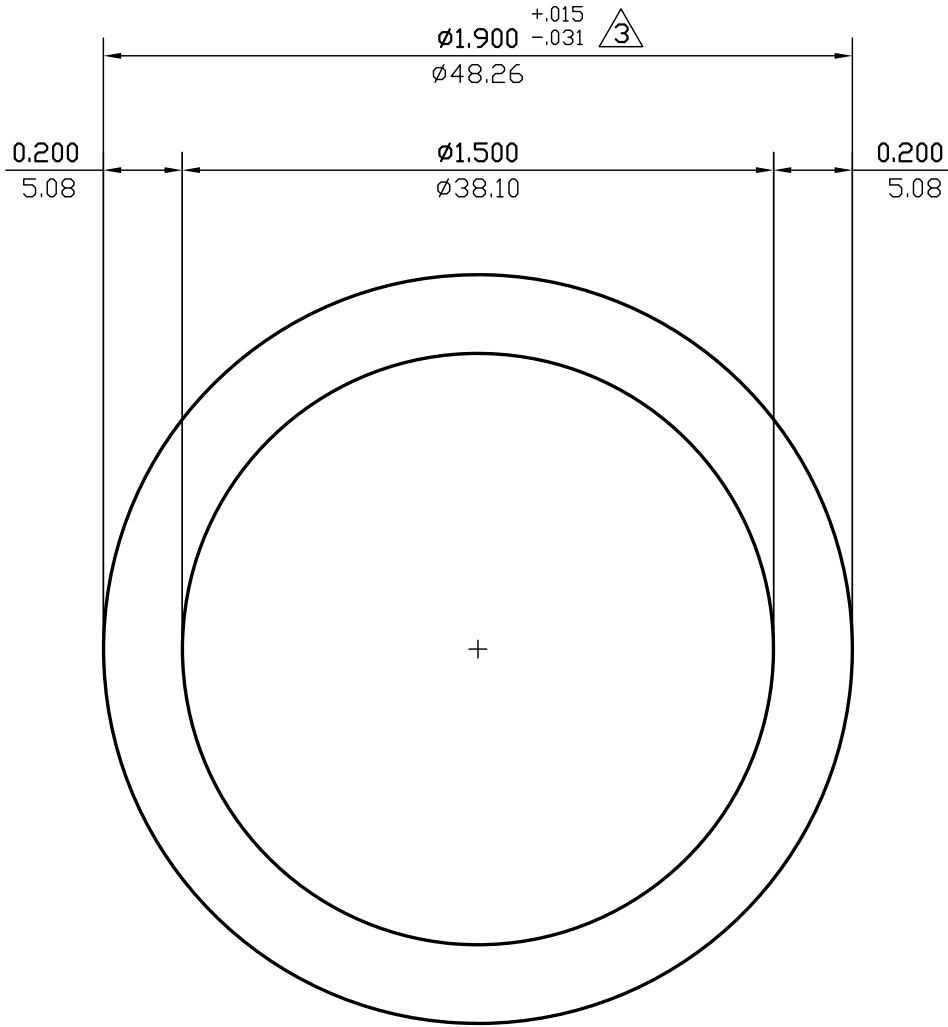

ACTUAL SIZE

WALL THICKNESS 0.200 (5.08) EXCEPT AS SHOWN

DATE	REV	DESCRIPTION	BY		
03/10/23	4	REMOVED EXPOSED SURFACES AND ALLOY	JASON		
07/13/15	3	ADDED +0.015/-0.031 TOLERANCE. REMOVED HOUSING/INSERT NOTE.	P.M.		
EST.AREA	1.068	IN. ²	EST.AREA	689	MM. ²
EST.WT.	1.260	LBS/FT.	EST.WT.	1.876	KG/M.
EST.PER.	10.681	IN.	EST.PER.	271.3	MM.
OUT PER.	5.969	IN.	OUT PER.	151.6	MM.
C.C.D.	1.900	IN.	C.C.D.	48	MM.
FACTOR	8	FINISH	M/F	ALLOY & TEMP.	
CKD BY		SCALE	2:1	DWN BY	J.D.
				DATE	02/28/92

CAN ART

ALUMINUM EXTRUSION INC.

85 PARKSHORE DRIVE
BRAMPTON, ONT L6T 5M1
TEL. NO. (905) 791-1464
FAX NO. (905) 791-9151
E-MAIL: canart@canart.com

THIS DRAWING IS NOT NECESSARILY A COPY OF YOUR ORIGINAL. PLEASE APPROVE DIMENSIONS AND TOLERANCES INDICATED. CAN ART ASSUMES NO RESPONSIBILITY EITHER TECHNICAL OR LEGAL FOR HAVING THIS SHAPE MADE. THE CUSTOMER AGREES TO FULLY PROTECT CAN ART ALUMINUM FROM CLAIMS OF OTHERS RESULTING FROM THIS SHAPE.

SIGNED: _____ DATE: _____

NOTE: BREAK ALL CORNERS WITH 0.015" (.38 MM) RADIUS UNLESS OTHERWISE SPECIFIED. STANDARD TOLERANCES TO APPLY UNLESS OTHERWISE SPECIFIED.